



BLUETOOTH® WIRELESS  
TECHNOLOGY DEVICES FOR  
BUILDING AUTOMATION



## BLUETOOTH® WIRELESS TECHNOLOGY DEVICES FOR BUILDING AUTOMATION

### **Blu2Light – The intelligent wireless lighting control solution**

Blu2Light is the first completely open Bluetooth® wireless technology system with mesh functionality for the professional lighting market, which, in addition to a variety of functions for lighting control, offers the luminaire manufacturer added IoT benefits with maximum system security.

### **Blu2Light Server Unit**

The Blu2Light Server Unit combines all the necessary server components for simple B2L systems in a compact control cabinet.

The Blu2Light Server Unit enables the hardware integration of small and simple B2L networks and establishes the connection between a Bluetooth® mesh network and an IP network.

Configuration is carried out using the LiNA server software.

### **Blu2Light Server Unit**

- **CONFIGURATION VIA LINA SERVER SOFTWARE**
- **DATA CONVERSION FROM BLUETOOTH® TO IP NETWORK**
- **COMPACT HARDWARE INTEGRATION OF SMALL AND SIMPLE B2L NETWORKS**

## Blu2Light Server Unit

### Field of application

- for building automation, IoT communication

### Functions

- System diagnosis
- Real-time clock
- Monitoring of energy consumption
- Heat map (demand statistics)
- Beacon tracking applications
- Spatial navigation, spatial planning
- Data processing for automated building management systems



| Type                            | Blu2Light Server Unit                                    |
|---------------------------------|----------------------------------------------------------|
| Ref. No.                        | 187523                                                   |
| Communication                   | Blu2Light Mesh Network / Ethernet protocol (LAN)         |
| Frequency range                 | 2402–2480 MHz                                            |
| HF output power                 | < 10 mW EIRP                                             |
| Power consumption operation     | < 1.50 W                                                 |
| Power supply                    | 230 V AC 50...60 Hz                                      |
| Ambient temperature $t_a$       | 0–35 °C                                                  |
| IP protection                   | IP65                                                     |
| Dimensions (WxHxL)              | 350 mm x 500 mm x 190 mm                                 |
| Casing                          | Wall-mounted enclosure, ABS, grey, with transparent door |
| Weight                          | 7.4 kg                                                   |
| Primary conductor cross-section | 2.5 mm <sup>2</sup>                                      |
| Software                        | LiNA Server                                              |
| Operating devices               | Apple iPad / Web interface                               |

### Dimensions

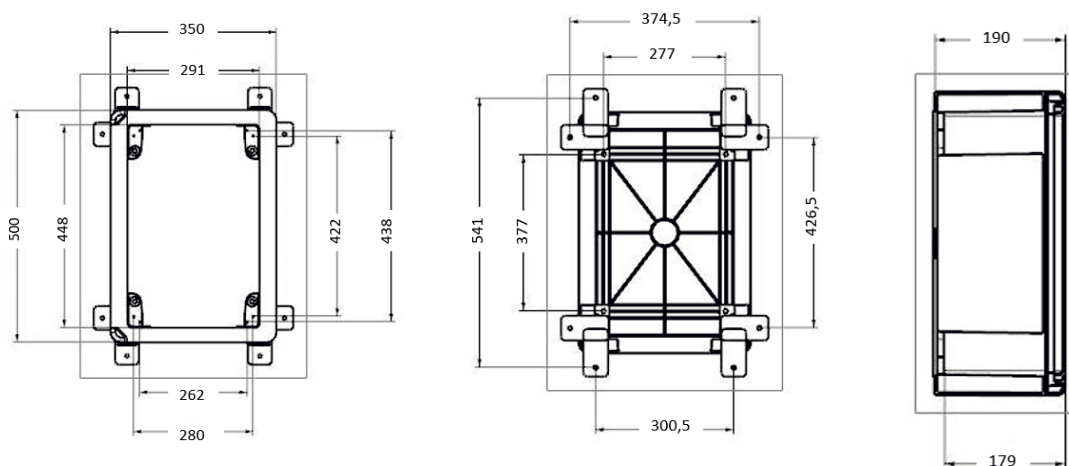

The values in this data sheet may change due to technical innovations and are subject to change without notice.

## Blu2Light Server Unit

### Wiring diagram

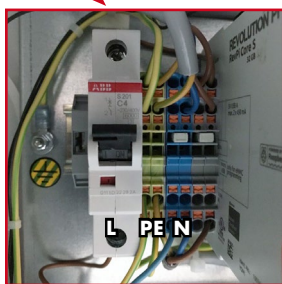
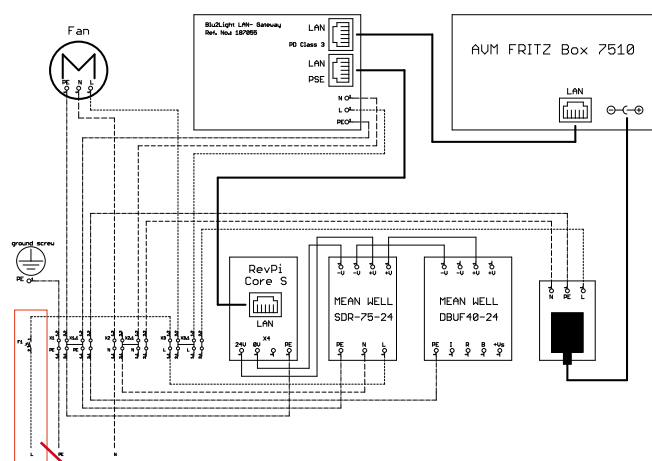

### General Safety Instructions

- Only qualified persons are allowed to install and start up Blu2Light products.
- Prior to installing and commissioning the system, read these instructions carefully. Only this will guarantee correct and safe handling. Please keep these instructions as you may need them later.
- The devices must always be disconnected before any work is carried out on them.
- The applicable safety and accident prevention regulations must be observed.
- Opening by unqualified personnel of the products is prohibited: Risk of death from electric shock!  
The devices must only be repaired by the manufacturer.
- If the appliance is permanently connected to the mains, a mains isolator switch must be provided to disconnect all poles of the appliance from the mains. The protective earth conductor (PE) must be connected. The outer conductor (L) must be connected to the corresponding connection of fuse F1.
- After disconnecting the Blu2Light Server Unit from the mains, the system will only be completely de-energised after a few minutes. Ensure that the system is de-energised before carrying out any electrical work.
- Depending on the ambient conditions, regular cleaning of the fan or replacement of the filter mat is recommended.
- Some components can be optionally deselected if they are already installed by the customer, such as the router.

### Mounting

- Installation is only permitted in dry indoor areas.
- The conductor cross-section for the mains-side connection is 2.5 mm<sup>2</sup> for rigid or flexible cables.
- Ambient temperature of 0-35 °C.
- If the device is mounted on the wall or ceiling, ensure that the mounting surface is smooth. The screws used must have a minimum length of 8 mm. The opening for the PG screw connection must be drilled by the customer. Care must be taken to ensure that no cables or devices are damaged during drilling. The drilling chips must be removed. When selecting the server unit without a router, please note that the PG gland must be suitable for feeding through the mains cable and LAN cable.

### Power supply

This product requires a power supply of 230 V AC.

### Setup and operation

- The local Blu2Light devices are configured using the LiNA Connect app. The local B2L system is then transferred to the LiNA server.
- For the exact procedure for configuring the devices, please follow the instructions in the LiNA Connect app or in the corresponding documentation for the LiNA server.
- A tablet or PC is required for the setup; these are not included in the scope of delivery.
- For information on the iOS and Android operating systems that can currently be used, refer to the LiNA Connect/ LiNA Touch manual:



### Bluetooth® wireless technology

The Bluetooth® word mark and logos are registered trademarks owned by the Bluetooth SIG, Inc. and any use of such marks by Vossloh-Schwabe is under license. Other trademarks and trade names are those of their respective owners.

### Important note:

Please refer to the installation instructions included with the product and the applicable Blu2Light system data sheet before installation. Make sure that the Bluetooth radio signal can propagate freely according to the specifications.



We, Vossloh-Schwabe Deutschland GmbH, herewith confirm that these devices comply with the basic requirements of the directive 2014/53/EU and other relevant directives. The entire text of the declaration of conformity can be obtained from the following address: [www.vossloh-schwabe.com](http://www.vossloh-schwabe.com)

Vossloh-Schwabe Deutschland GmbH  
Stuttgarter Straße 61/1, D-73614 Schorndorf, Germany

The values in this data sheet may change due to technical innovations and are subject to change without notice.